

Series 30 Floor Register

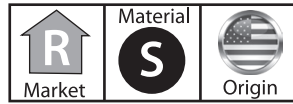

- Steel construction
- Patented design
- Rolled face
- Opposed blade damper
- One-piece wraparound collar for increased strength
- With mounting holes
- Available sizes: 2 1/4", 4", 6" widths
- Golden Brown or White finish
- Made in the U.S.A.

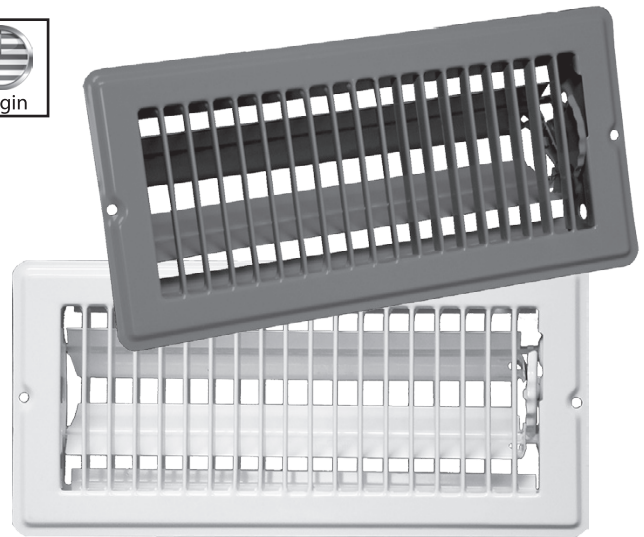

Residential
Floor & Baseboard

Dimensional Drawings

2 1/4" Floor Register

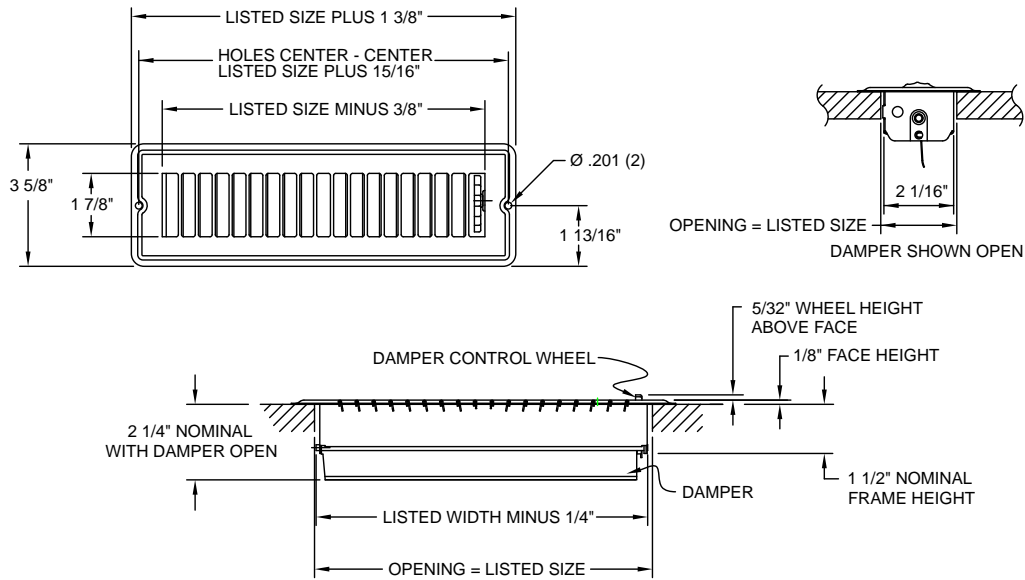

4" Floor Register

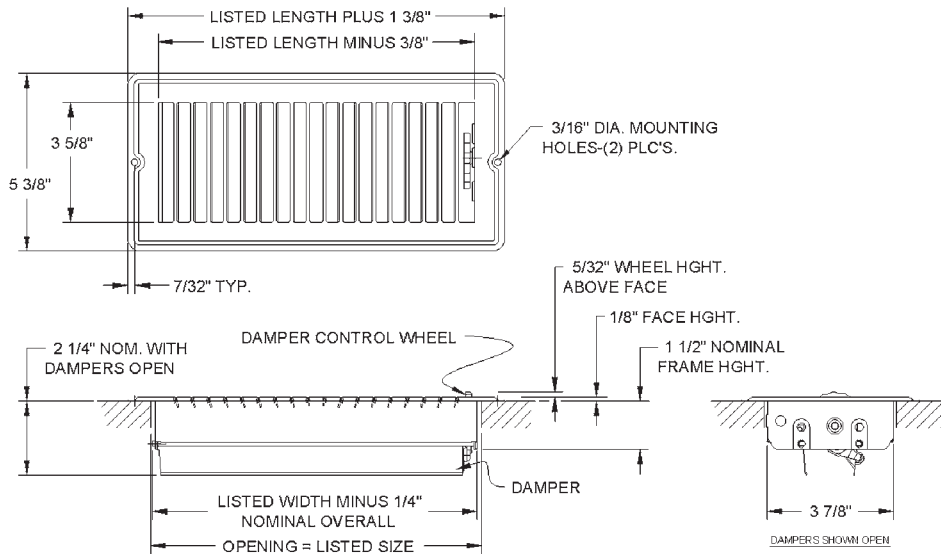

6" Floor Register

Residential
Floor & Baseboard

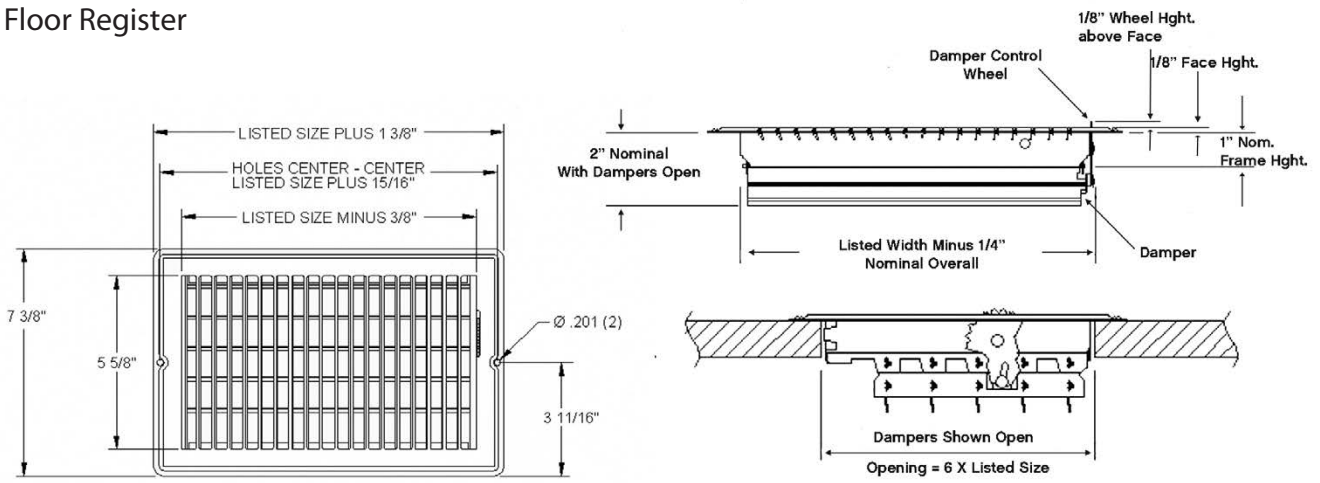

Performance Data, Series 30

Unit Size (in.)	Overall Size (in.)	Face Velocity	300	400	500	600	700	800	900	1000
		Pressure Loss	.006	.010	.016	.022	.031	.040	.050	.062
2 1/4 x 10 Ak .097	3 5/8 x 11 3/8	Cfm	29	38	48	58	68	77	87	97
		Throw	2	3	3.5	4	4.5	5	6	6.5
		Spread	3.5	4.5	5	6.5	7.5	8.5	10	11
2 1/4 x 12 Ak .118	3 5/8 x 13 3/8	Cfm	35	47	59	70	82	94	106	118
		Throw	2	3	3.5	4	4.5	5.5	6	7
		Spread	3.5	5	5	7	8	10	11	12
4 x 8 Ak .139	5 3/8 x 9 3/8	Cfm	41	55	69	83	97	111	124	138
		Throw	2	2.5	3	3.5	4	4.5	5	6
		Spread	3	4	5	6	7	8	9	10
4 x 10 Ak .174	5 3/8 x 11 3/8	Cfm	52	69	86	104	121	138	156	173
		Throw	2.5	3	4	4.5	5.5	6.5	7	8
		Spread	4	4.5	6.5	8.5	9.5	11	12.5	14
4 x 12 Ak .208	5 3/8 x 13 3/8	Cfm	62	83	104	124	145	166	187	208
		Throw	2.5	3.5	4	5.5	6	7	8	8.5
		Spread	4	6	7.5	9	10.5	12	13.5	15.5
6 x 10 Ak .243	7 3/8 x 11 3/8	Cfm	80	110	135	160	190	215	245	270
		Throw	3.5	4.5	6	7	8	9	10.5	11.5
		Spread	6	8	10	11.5	13.5	15.5	17.5	19.5
6 x 12 Ak .299	7 3/8 x 13 3/8	Cfm	100	130	165	200	230	265	295	330
		Throw	4	5	6.5	7.5	9	10	11.5	12.5
		Spread	6.5	8.5	11	13	15	17	19.5	21.5

Terminal velocity is 50 fpm. Always specify width by height.