

## Gas Venting Systems

residential•industrial•commercial



AirJet Gas Vent is listed by  
Underwriters  
Laboratories,  
Standard UL-441,  
and accepted by  
FHA, VA, BOCA, ICBO and  
SBC



# Superior gas venting for every installation

Engineered design gives you more features for fast assembly, long lasting service-top performance in Type "B" gas venting systems for all applications.

## Superior construction

Each pipe section is carefully assembled with a self-oxidizing aluminum inner liner, Type 3003-12. Outer pipe is made of heavy duty galvanized with .018 minimum gauge. UL listing file MH 6512-volume.

Type "B" gas vent UL 441 listed and tested to 470° F. Maximum temperature. 1" clearance to combustibles.

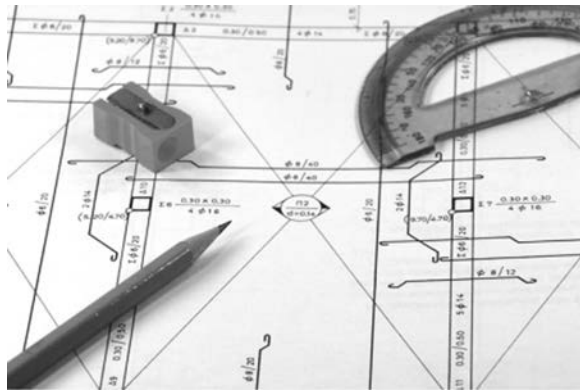

Long an industry leader in technology, AirJet carries on a full program of research and testing for improved design and solution of venting problems.

AirJet's staff is prepared to assist you with any questions or advice you might need for particular applications. For this customer service, you are invited to contact a nearby AirJet representative/distributor, or its headquarters in Elkhart, Indiana.

## Field service

Our complete network of representatives and distributors is your insurance of a quick response to venting questions. Solutions to your venting problems are nearby and readily available from highly-trained and experienced AirJet representatives.



## Snap-lock speed

For faster installing, AirJet gives you "Snap-Lock" assembly. No twisting, no screws. **Just line up seams, slide one section into the other, and snap securely in place.** Joints are locked by an exclusive AirJet design. Easily unlocked by twisting counter-clockwise.

## Large inventories

For all sizes of venting systems, AirJet maintains complete stocks at the plant.



## Rolled ends for extra strength

Male ends are fully rolled 360° to give added strength, overcome shipping or handling damage. Extra strong cartons, too-engineered from 200 lb. test board with four fold flap top. Other outstanding features: leak-proof base flashing. . . true diameter. . . complete line 3" through 24" in stock, through 48" on special order.



## How to Specify AirJet Type "B" Gas Venti

### Sample Specification

The gas vent system shall be so engineered and constructed as to develop a positive flow adequate to the outside atmosphere, without condensation within the vent and without spillage at any appliance. The system shall be sized and installed in accordance with the National Fuel Gas Code (NFPA 54). All flue-gas carrying parts of the vent system shall be AirJet Type "B": double-wall gas vent piping as shown from the appliances' outlets into the AirJet vent top or housing. AirJet gas vent piping shall be installed in full compliance with the terms of its Underwriters' Laboratories manufacturer's installation instructions, and with nationally recognized good practice for such installations.

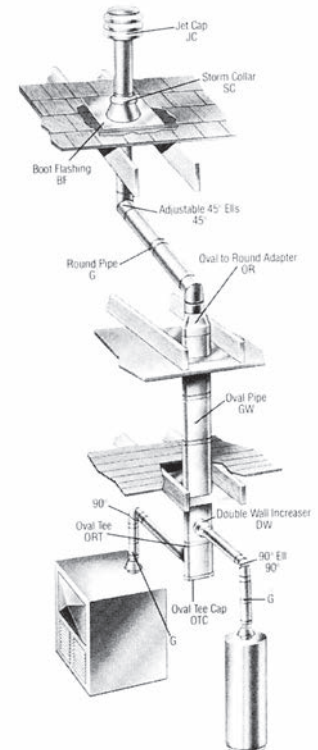

AIR-JET Installation Showing Various Items

# Round pipe and fittings 3" - 12"

## Round Pipe

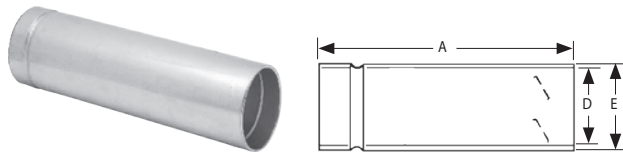

- A Stated Length
- D Stated Diameter
- E Stated Diameter + 3/4"

## Adjustable Pipe (AR1/2)

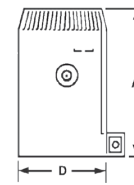

	A	D
3AR $\frac{1}{2}$	6"	3"
4AR $\frac{1}{2}$	6"	4"
5AR $\frac{1}{2}$	6"	5"
6AR $\frac{1}{2}$	6"	6"
7AR $\frac{1}{2}$	6"	7"
8AR $\frac{1}{2}$	6"	8"

All pipes are adjustable in length— with a minimum of 2 $\frac{5}{8}$ " and a maximum of 5". UL Listed for use on male end other manufacturers' pipe and fittings.

## Adjustable Pipe (AR1)

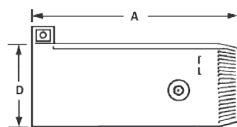

	A	D
3AR1	12"	3"
4AR1	12"	4"
5AR1	12"	5"
6AR1	12"	6"
7AR1	12"	7"
8AR1	12"	8"
10AR1	12"	10"
12AR1	12"	12"

All pipes are adjustable in length – with a minimum of 2 $\frac{5}{8}$ " and a maximum of 10 $\frac{1}{2}$ ".

## Female Universal Adapter

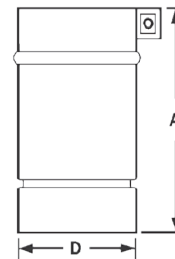

	A	D
3FUA	8"	3 $\frac{3}{4}$ "
4FUA	8"	4 $\frac{3}{4}$ "
5FUA	8"	5 $\frac{3}{4}$ "
6FUA	8"	6 $\frac{3}{4}$ "
7FUA	8"	7 $\frac{3}{4}$ "
8FUA	8"	8 $\frac{3}{4}$ "

UL Listed for use on female end other manufacturers' pipe and fittings.

## 45° Elbow

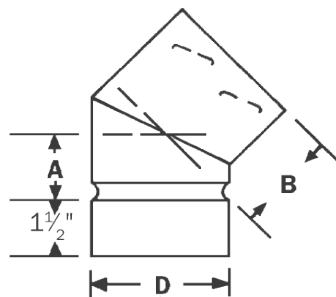

	A	B	D
3-45	2 $\frac{1}{2}$ "	2 $\frac{7}{8}$ "	3 $\frac{3}{4}$ "
4-45	2 $\frac{5}{8}$ "	3 $\frac{1}{8}$ "	4 $\frac{3}{4}$ "
5-45	2 $\frac{5}{8}$ "	3 $\frac{1}{4}$ "	5 $\frac{3}{4}$ "
6-45	2 $\frac{3}{4}$ "	3 $\frac{5}{8}$ "	6 $\frac{3}{4}$ "
7-45	3"	4"	7 $\frac{3}{4}$ "
8-45	3 $\frac{1}{4}$ "	3 $\frac{7}{8}$ "	8 $\frac{3}{4}$ "
10-45	3 $\frac{3}{4}$ "	4 $\frac{1}{2}$ "	10 $\frac{3}{4}$ "
12-45	4 $\frac{1}{8}$ "	4 $\frac{1}{2}$ "	12 $\frac{3}{4}$ "

## 90° Elbow

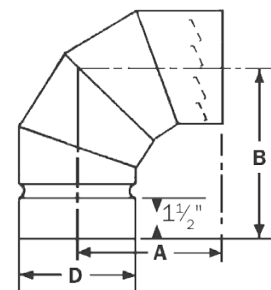

	A	B	D
3-90	5 $\frac{5}{16}$ "	5 $\frac{7}{16}$ "	3 $\frac{3}{4}$ "
4-90	6 $\frac{25}{32}$ "	6 $\frac{21}{32}$ "	4 $\frac{3}{4}$ "
5-90	6 $\frac{3}{4}$ "	6 $\frac{5}{16}$ "	5 $\frac{3}{4}$ "
6-90	7"	6 $\frac{1}{8}$ "	6 $\frac{3}{4}$ "
7-90	7 $\frac{9}{16}$ "	6 $\frac{3}{4}$ "	7 $\frac{3}{4}$ "
8-90	8 $\frac{3}{8}$ "	7 $\frac{9}{16}$ "	8 $\frac{3}{4}$ "

## 90° Elbow as Offset

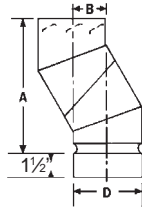

	A	B	D
3-90	8 <sup>11</sup> / <sub>16</sub> "	2 <sup>1</sup> / <sub>16</sub> "	3 <sup>3</sup> / <sub>4</sub> "
4-90	9 <sup>1</sup> / <sub>8</sub> "	2 <sup>15</sup> / <sub>16</sub> "	4 <sup>3</sup> / <sub>4</sub> "
5-90	12"	2 <sup>11</sup> / <sub>16</sub> "	5 <sup>3</sup> / <sub>4</sub> "
6-90	10 <sup>1</sup> / <sub>4</sub> "	2 <sup>27</sup> / <sub>32</sub> "	6 <sup>3</sup> / <sub>4</sub> "
7-90	11 <sup>13</sup> / <sub>16</sub> "	3 <sup>1</sup> / <sub>8</sub> "	7 <sup>3</sup> / <sub>4</sub> "
8-90	12 <sup>5</sup> / <sub>16</sub> "	3 <sup>5</sup> / <sub>8</sub> "	8 <sup>3</sup> / <sub>4</sub> "

## Tee

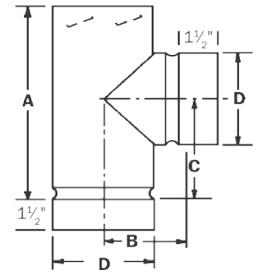

	A	B	C	D
4RT	9"	3 <sup>3</sup> / <sub>4</sub> "	4 <sup>11</sup> / <sub>16</sub> "	4 <sup>3</sup> / <sub>4</sub> "
5RT	10 <sup>1</sup> / <sub>16</sub> "	4 <sup>1</sup> / <sub>16</sub> "	5 <sup>1</sup> / <sub>8</sub> "	5 <sup>3</sup> / <sub>4</sub> "
6RT	11"	4 <sup>3</sup> / <sub>4</sub> "	5 <sup>5</sup> / <sub>8</sub> "	6 <sup>3</sup> / <sub>4</sub> "
7RT	12"	5 <sup>1</sup> / <sub>8</sub> "	6 <sup>3</sup> / <sub>8</sub> "	7 <sup>3</sup> / <sub>4</sub> "
8RT	13 <sup>1</sup> / <sub>16</sub> "	5 <sup>13</sup> / <sub>16</sub> "	6 <sup>13</sup> / <sub>16</sub> "	8 <sup>3</sup> / <sub>4</sub> "
10RT	14"	6 <sup>1</sup> / <sub>4</sub> "	6 <sup>7</sup> / <sub>16</sub> "	10 <sup>3</sup> / <sub>4</sub> "
12RT	17 <sup>3</sup> / <sub>16</sub> "	8 <sup>5</sup> / <sub>16</sub> "	8 <sup>1</sup> / <sub>8</sub> "	12 <sup>3</sup> / <sub>4</sub> "

## Tee Cap

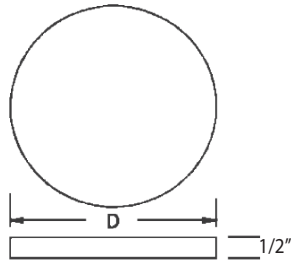

	D
3RTC	3 <sup>3</sup> / <sub>4</sub> "
4RTC	4 <sup>3</sup> / <sub>4</sub> "
5RTC	5 <sup>3</sup> / <sub>4</sub> "
6RTC	6 <sup>3</sup> / <sub>4</sub> "
7RTC	7 <sup>3</sup> / <sub>4</sub> "
8RTC	8 <sup>3</sup> / <sub>4</sub> "
10RTC	10 <sup>3</sup> / <sub>4</sub> "
12RTC	12 <sup>3</sup> / <sub>4</sub> "

## Termination Cap

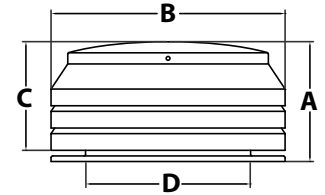

	A	B	C	D
3JC	6"	6 <sup>1</sup> / <sub>2</sub> "	4 <sup>7</sup> / <sub>8</sub> "	3 <sup>1</sup> / <sub>16</sub> "
4JC	6"	6 <sup>1</sup> / <sub>2</sub> "	4 <sup>7</sup> / <sub>8</sub> "	4 <sup>1</sup> / <sub>16</sub> "
5JC	5 <sup>7</sup> / <sub>8</sub> "	10 <sup>1</sup> / <sub>2</sub> "	4 <sup>7</sup> / <sub>8</sub> "	5 <sup>1</sup> / <sub>16</sub> "
6JC	7 <sup>7</sup> / <sub>8</sub> "	10 <sup>1</sup> / <sub>2</sub> "	6 <sup>7</sup> / <sub>8</sub> "	6 <sup>1</sup> / <sub>16</sub> "
7JC	7 <sup>7</sup> / <sub>8</sub> "	10 <sup>1</sup> / <sub>2</sub> "	6 <sup>7</sup> / <sub>8</sub> "	7 <sup>1</sup> / <sub>16</sub> "
8JC	9 <sup>7</sup> / <sub>8</sub> "	10 <sup>1</sup> / <sub>2</sub> "	8 <sup>7</sup> / <sub>8</sub> "	8 <sup>1</sup> / <sub>16</sub> "
10JC	9 <sup>7</sup> / <sub>8</sub> "	15 <sup>1</sup> / <sub>2</sub> "	8 <sup>7</sup> / <sub>8</sub> "	10 <sup>3</sup> / <sub>4</sub> "
12JC	13 <sup>3</sup> / <sub>8</sub> "	15"	12 <sup>1</sup> / <sub>2</sub> "	12 <sup>3</sup> / <sub>4</sub> "

## Storm Collar

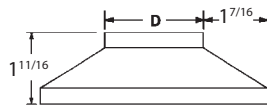

	D
3SC	3 <sup>3</sup> / <sub>4</sub> "
4SC	4 <sup>3</sup> / <sub>4</sub> "
5SC	5 <sup>3</sup> / <sub>4</sub> "
6SC	6 <sup>3</sup> / <sub>4</sub> "
7SC	7 <sup>3</sup> / <sub>4</sub> "
8SC	8 <sup>3</sup> / <sub>4</sub> "
10SC	10 <sup>3</sup> / <sub>4</sub> "
12SC	12 <sup>3</sup> / <sub>4</sub> "

## Swivel Fitting

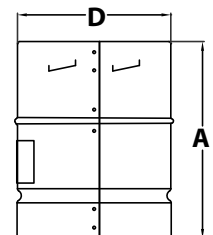

	A	D
3GSW	6 <sup>7</sup> / <sub>8</sub> "	3 <sup>5</sup> / <sub>8</sub> "
4GSW	7"	4 <sup>5</sup> / <sub>8</sub> "
5GSW	7 <sup>15</sup> / <sub>16</sub> "	5 <sup>5</sup> / <sub>8</sub> "
6GSW	7 <sup>15</sup> / <sub>16</sub> "	6 <sup>5</sup> / <sub>8</sub> "

### Adjustable Boot Flashing

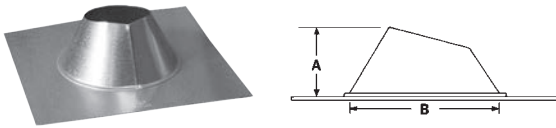

	A	B
3BF	5 1/2"	8 3/16"
4BF	4 1/2"	8 3/16"
5BF	5 1/2"	10 1 1/16"
6BF	5 3/16"	10 1 1/16"
7BF	7 1/4"	13 1 1/16"
8BF	6 1/8"	13 1 1/16"
10BF	8 1/2"	16 1/4"
12BF	8 5/8"	16 1/4"

Note: Flashing adjusts from flat to 6/12 pitch.

### Steep Pitch Flashing

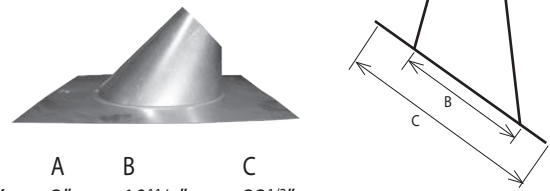

	A	B	C
3BFX	3"	10 1 1/16"	23 1/2"
4BFX	4"	10 1 1/16"	23 1/2"
5BFX	5"	13 1 1/16"	23 1/2"
6BFX	6"	13 1 1/16"	23 1/2"
7BFX	7"	13 1 1/16"	23 1/2"
8BFX	8"	16 1/4"	23 1/2"
10BFX	10"	20"	28"
12BFX	12"	20"	28"

Note: BFX 7/12–12/12, BFY 13/12–18/12, BFZ 19/12–24/12

### Tall Cone Flashing

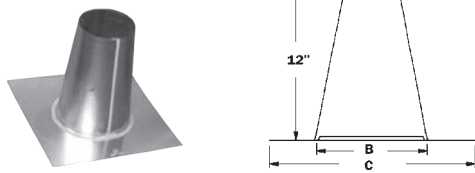

	A	B	C
3BFT	3 7/8"	8 13/16"	15 5/32"
4BFT	4 7/8"	8 13/16"	15 5/32"
5BFT	5 7/8"	8 13/16"	15 5/32"
6BFT	6 7/8"	10 1 1/16"	18 5/16"
7BFT	7 7/8"	10 1 1/16"	18 5/16"
8BFT	8 7/8"	10 1 1/16"	18 5/16"
10BFT	10 7/8"	13 1 1/16"	21 7/16"
12BFT	12 7/8"	14 5/8"	24 19/32"

Note: Soldered Flashings available on special order.

### Base Assembly

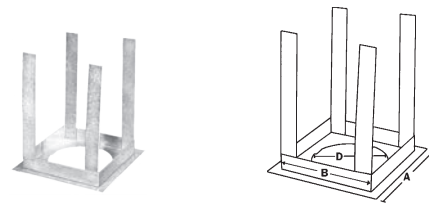

	A	B	D
3BA	10 1/2"	5 5/8"	3 3/4"
4BA	10 1/2"	6 5/8"	4 3/4"
5BA	10 1/2"	7 5/8"	5 3/4"
6BA	10 1/2"	8 5/8"	6 3/4"
7BA	11 1/4"	9 5/8"	7 3/4"
8BA	12 1/4"	10 5/8"	8 3/4"
10BA	15 1/4"	13 5/8"	10 3/4"
12BA	17 1/4"	15 5/8"	12 3/4"

### Draft Hood Connector

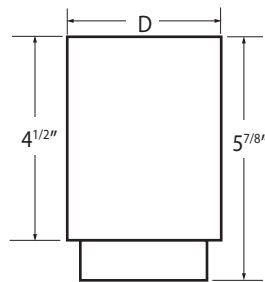

	D
3DHC	3 5/8"
4DHC	4 5/8"
5DHC	5 5/8"
6DHC	6 5/8"
7DHC	7 5/8"
8DHC	8 5/8"

Note: Aluminum extension can be formed to fit oval draft hood outlets of furnaces.

### Wall Thimble

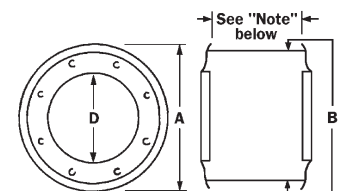

	D	A	B
3VT	3 3/4"	6 3/4"	5 7/8"
4VT	4 3/4"	9 3/8"	8 1/2"
5VT	5 3/4"	9 3/8"	8 1/2"
6VT	6 3/4"	10 3/4"	9 1/2"
7VT	7 3/4"	12 1/2"	11 1/2"
8VT	8 3/4"	12 1/2"	11 1/2"

Note: Adjustable – 4" minimum, 6 1/2" maximum.

## Firestop

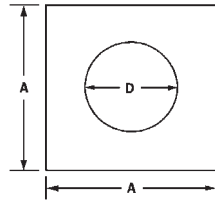

	A	D
3GF	12 $\frac{1}{2}$ "	3 $\frac{3}{4}$ "
4GF	12 $\frac{1}{2}$ "	3 $\frac{3}{4}$ "
5GF	12 $\frac{1}{2}$ "	3 $\frac{3}{4}$ "
6GF	12 $\frac{1}{2}$ "	3 $\frac{3}{4}$ "
7GF	12 $\frac{1}{2}$ "	3 $\frac{3}{4}$ "
8GF	19 $\frac{1}{4}$ "	3 $\frac{3}{4}$ "
10GF	19 $\frac{1}{4}$ "	3 $\frac{3}{4}$ "
12GF	19 $\frac{1}{4}$ "	3 $\frac{3}{4}$ "

## Pipe Collar

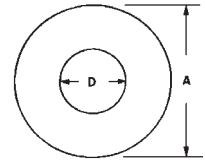

ITEM	A	D
3PC	9 $\frac{7}{8}$ "	3 $\frac{3}{4}$ "
4PC	9 $\frac{7}{8}$ "	4"
5PC	9 $\frac{7}{8}$ "	5"
6PC	9 $\frac{7}{8}$ "	6"
7PC	10 $\frac{13}{16}$ "	7"

## Interior Support Band

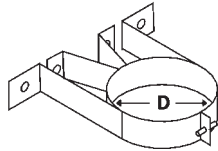

	D
3ISB	3 $\frac{5}{8}$ "
4ISB	4 $\frac{5}{8}$ "
5ISB	5 $\frac{5}{8}$ "
6ISB	6 $\frac{5}{8}$ "
7ISB	7 $\frac{5}{8}$ "
8ISB	8 $\frac{5}{8}$ "

## Double-Wall Inserter

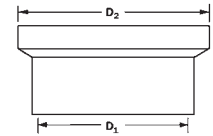

D1	First Stated Diameter
D2	Second Stated Diameter
Length	= 1 $\frac{3}{4}$ " plus additional 1/4" for each size difference between D1 and D2.

## Adjustable Pipe

### Round Pipe

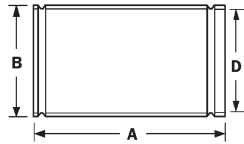

- A Stated Length (24" or 36")
- D Stated Diameter
- E Stated Diameter + 1"

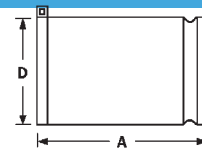

- A 18"
- D Stated Diameter

### 45° Elbow

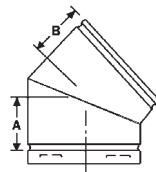

ITEM	A	B
14-45	5"	6"
16-45	5 1/2"	6 3/8"
18-45	6"	6 3/4"
20-45	7 3/8"	6 3/8"
22-45	7 3/8"	6 3/4"
24-45	8 1/4"	7"

### Tee

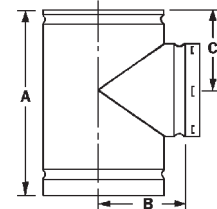

	A	B	C
14RT	24"	9 1/2"	9"
16RT	24"	10 1/2"	10"
18RT	27"	11 1/2"	11"
20RT	36"	12 1/2"	13"
22RT	36"	13 1/2"	14"
24RT	36"	14 1/2"	15"

### Termination Cap

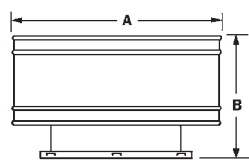

	A	B
14JC	28"	20 1/4"
16JC	32"	23"
18JC	36"	25 3/4"
20JC	40"	28 3/8"
22JC	44"	31 1/16"
24JC	48"	48 3/4"

### Storm Collar

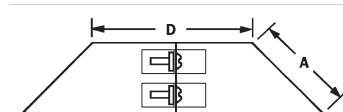

	A	D
14SC	4"	15"
16SC	4 1/2"	17"
18SC	5"	19"
20SC	6"	21"
22SC	7"	23"
24SC	8"	25"



## Base Assembly

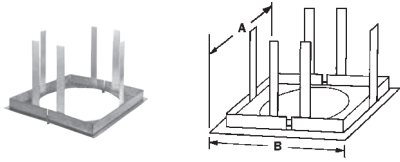

	A	B
14BA	17"	19"
16BA	19"	21"
18BA	21"	23"
20BA	23"	25"
22BA	25"	27"
24BA	27"	29"
26BA	29"	31"
28BA	31"	33"
30BA	33"	35"
32BA	35"	37"
34BA	37"	39"
36BA	39"	41"

## Adjustable Boot Flashing

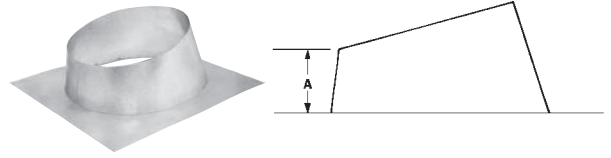

	A
14BF	5"
16BF	5½"
18BF	6"
20BF	6½"
22BF	7"
24BF	7½"
26BF	8"
28BF	8½"
30BF	9"
32BF	9½"
34BF	10"
36BF	10½"

Note: Boot flashing adjusts from flat to 5/12 pitch.

## Tall Cone Flashing

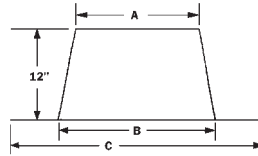
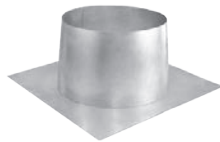

ITEM	A	B	C
14BFT	15½"	16¼"	24 <sup>19</sup> / <sub>32</sub> "
16BFT	17½"	18¾"	26 <sup>3</sup> / <sub>16</sub> "
18BFT	19½"	20¾"	28 <sup>3</sup> / <sub>4</sub> "
20BFT	21½"	22¾"	30 <sup>3</sup> / <sub>4</sub> "
22BFT	23½"	24¾"	32 <sup>3</sup> / <sub>4</sub> "
24BFT	25½"	26"	34"
26BFT	27½"	28¼"	36 <sup>19</sup> / <sub>32</sub> "
28BFT	29½"	30¾"	38 <sup>3</sup> / <sub>16</sub> "
30BFT	31½"	32¾"	40 <sup>3</sup> / <sub>4</sub> "
32BFT	33½"	34¾"	42 <sup>3</sup> / <sub>4</sub> "
34BFT	35½"	36¾"	44 <sup>3</sup> / <sub>4</sub> "
36BFT	37½"	38"	46"

# B-Vent Kits

## Termination Kit A

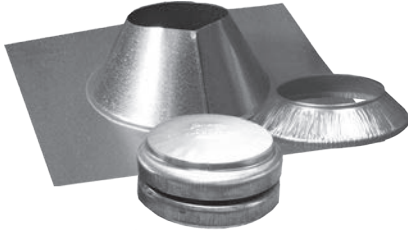

## Termination Kit B

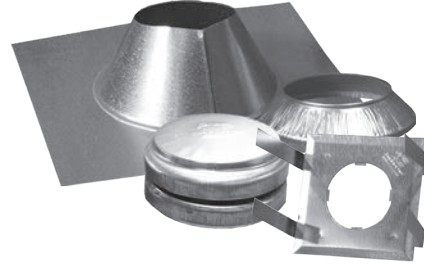

## Termination Cap

Bird-proof louvered cap looks great on homes, garden apartments or commercial installations. Keeps out rain, snow, down drafts. Diameters—3" through 12".

Simplest housing assembly on the market. Only eight parts—entire unit can be assembled on the ground, attached to roof by one man! Compact package contains everything you need in one carton. UL approved for use with gas. Rancher top of high grade stainless steel guards against birds, leaves and weather. Housing measures 17" X 17". Available in brick pattern or plain. (All housings available in 3', 4', 5' or 6' heights.)

## Wind-tested and UL listed

### Installation Recommendations Type B Gas Vent Jet Cap 3" through 12"

AirJet Vent Caps have the "Wind" symbol embossed on top to show wind testing according to UL standards.

Roof Pitch	Minimum Height from Roof to Lowest Discharge Opening, Ft.
Flat to 7/12	1.0
Over 7/12 to 8/12	1.5
Over 8/12 to 9/12	2.0
Over 9/12 to 10/12	2.5
Over 10/12 to 11/12	3.25
Over 11/12 to 12/12	4.0

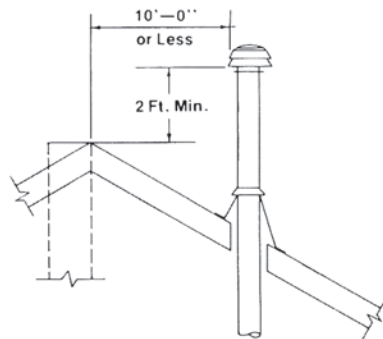
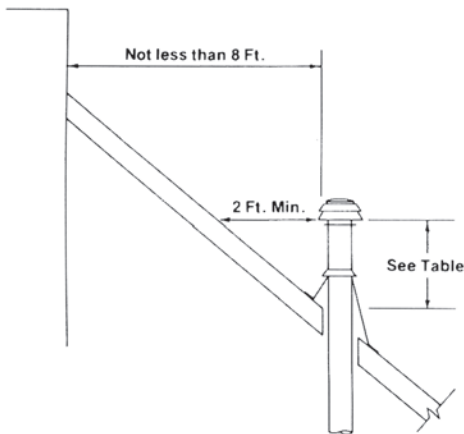

**Fig. 1** – This cap is suitable for installation on listed gas vents terminating a sufficient distance from the roof so that no discharge opening is less than two feet horizontally from the roof surface, and the lowest discharge opening will be no closer than the minimum height specified, provided that the vent is not less than eight feet from any vertical wall.

**Fig. 2** – For installations other than covered by the table, or closer than eight feet to any vertical wall, the cap shall be not less than two feet above the highest point where the vent passes through the roof and at least two feet higher than any portion of a building within ten feet.

## Gas Vent Connectors

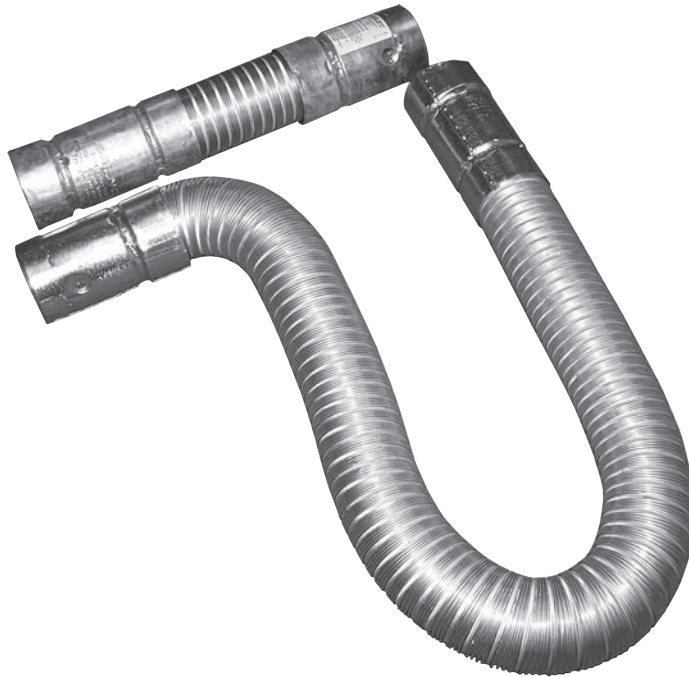

Durable single wall or double wall, air-insulated construction. Simplify installation by allowing an offset between rigid sections of pipe.

Available with Snap-Lock™ male and female ends for use with other AirJet venting components or Snap-Lock™ male and a Universal female connector. Available in diameters of 3, 4 and 5 inches and in lengths of 2, 3, 4 and 5 feet.

Safe for use in conditioned or unconditioned spaces.

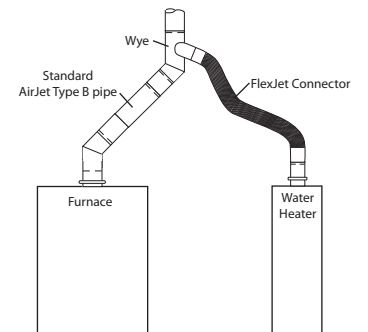

## AIRJET INTRODUCES NEW COLOR

- Color swatches are available
- Chimney housing kit can be purchased and displayed

### Decorative Chimney Housing Kits



Red



Tan



White

***THE SMART HOUSING ASSEMBLY THAT SAVES YOU TIME AND MONEY.***