

# Series PDS/APDS

## T-bar Diffuser

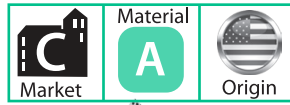

- Perforated face
- Steel construction (PDS)
- Aluminum construction (APDS)
- Fixed 14" collar and no collar models
- Insulation options: R1, R6 blankets
- 4-way diffuser option
- White finish
- Made in the U.S.A.

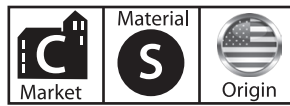
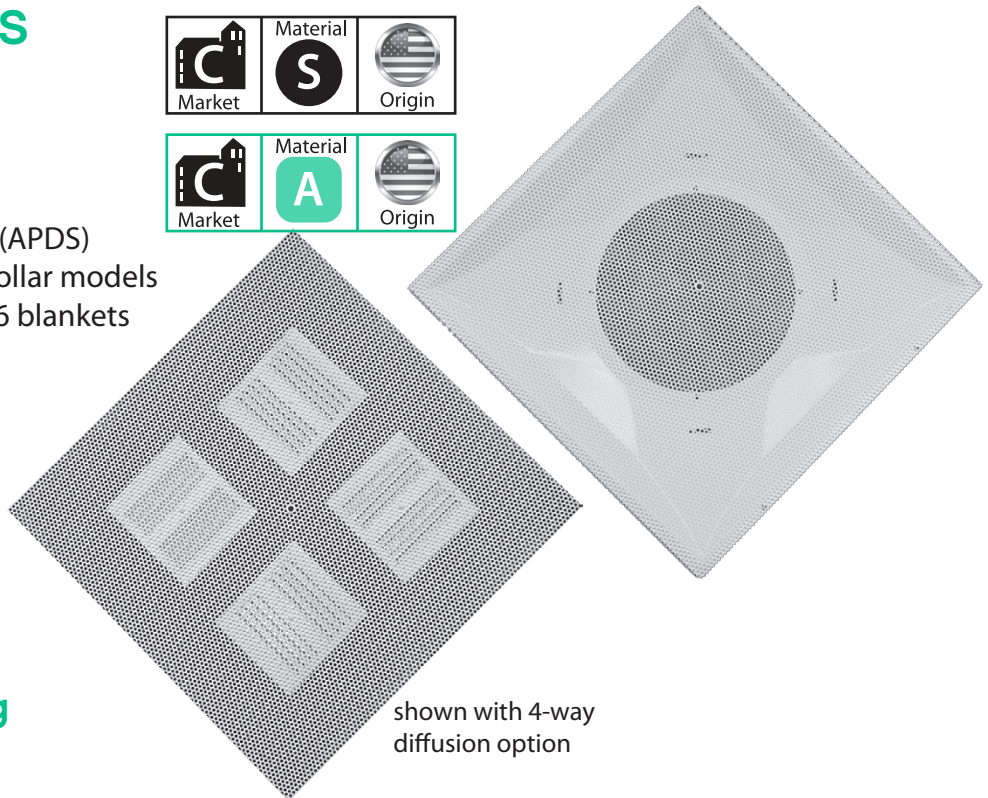

### Dimensional Drawing

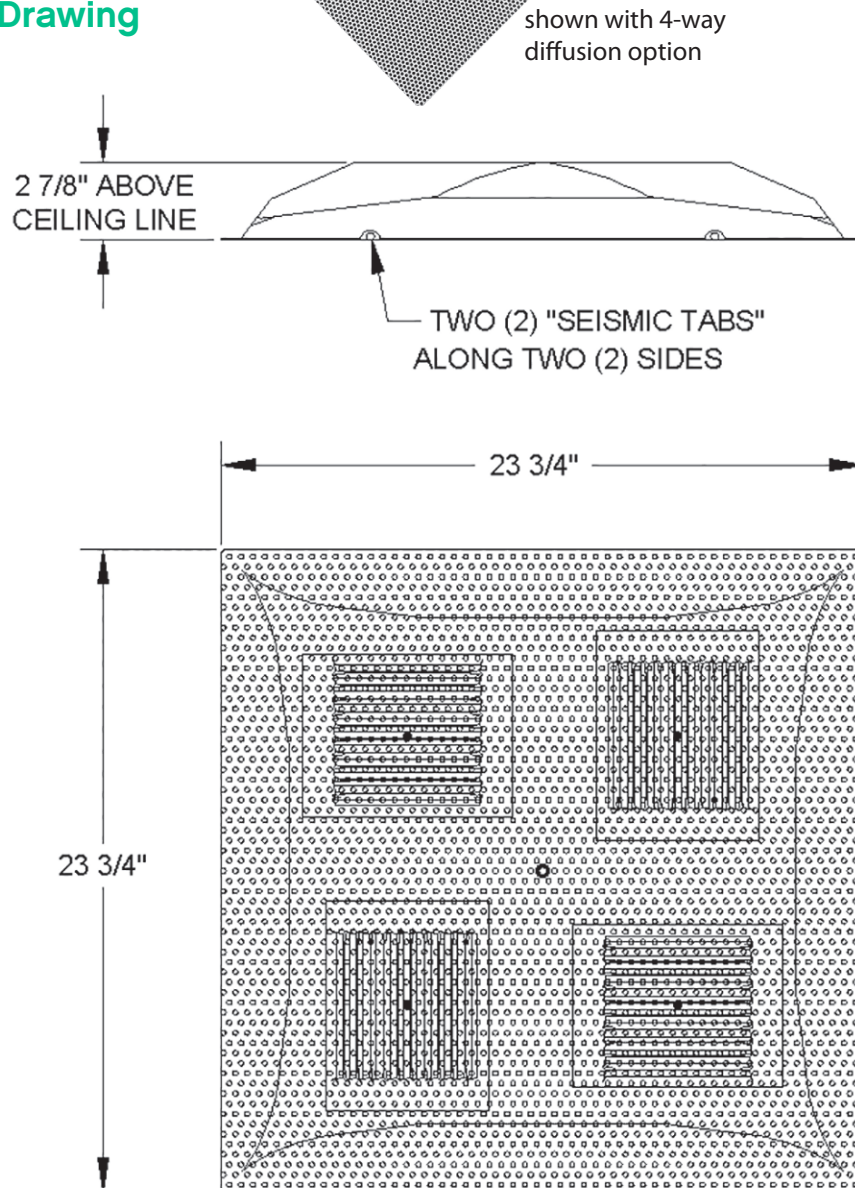

## Performance Data, Series PDS/APDS

Collar Size ↓	Neck Velocity →	300	400	500	600	700	800	900	1000
6" An .20	Cfm	59	79	98	118	137	157	177	196
	Ps	<.01	<.01	.013	.017	.024	.031	.039	.047
	Nc	<20 dB	<20 dB	<20 dB	22 dB	26 dB	30 dB	35 dB	40 dB
	Throw	4	5	6	7	9	10	12	15
7" An .27	Cfm	80	107	134	160	187	214	241	267
	Ps	<.01	.01	.014	.019	.027	.034	.043	.053
	Nc	<20 dB	<20 dB	20 dB	24 dB	28 dB	34 dB	38 dB	42 dB
	Throw	5	6	7	9	11	12	14	15
8" An .35	Cfm	105	140	175	209	244	279	314	349
	Ps	<.01	.01	.015	.021	.031	.038	.049	.059
	Nc	<20 dB	<20 dB	21 dB	26 dB	31 dB	39 dB	42 dB	>45 dB
	Throw	6	7	9	11	12	14	15	17
9" An .44	Cfm	133	177	221	265	309	353	398	442
	Ps	<.01	.011	.017	.024	.033	.043	.054	.066
	Nc	<20 dB	<20 dB	21 dB	26 dB	34 dB	40 dB	43 dB	>45 dB
	Throw	7	8	10	13	15	17	19	21
10" An .54	Cfm	164	218	273	327	282	436	491	545
	Ps	<.01	.012	.019	.027	.037	.048	.061	.075
	Nc	<20 dB	<20 dB	21 dB	26 dB	34 dB	40 dB	43 dB	>45 dB
	Throw	8	10	13	16	18	21	24	26
12" An .78	Cfm	236	314	393	471	550	628	707	785
	Ps	<.01	.014	.022	.033	.045	.061	.075	.093
	Nc	<20 dB	20 dB	25 dB	33 dB	40 dB	44 dB	>45 dB	>45 dB
	Throw	10	12	16	19	21	24	27	29
14" An 1.07	Cfm	321	428	535	641	748	855	962	1069
	Ps	<.01	.017	.027	.040	.055	.075	.093	.115
	Nc	<20 dB	20 dB	25 dB	30 dB	38 DB	45 dB	>45 dB	>45 dB
	Throw	11	14	19	22	25	28	31	34

Terminal velocity = 75 fpm