

Series PDS/APDS

T-bar Diffuser

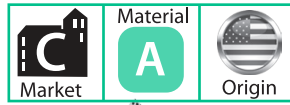

- Perforated face
- Steel construction (PDS)
- Aluminum construction (APDS)
- Fixed 14" collar and no collar models
- Insulation options: R1, R6 blankets
- 4-way diffuser option
- White finish
- Made in the U.S.A.

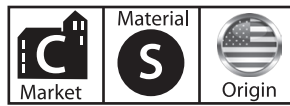
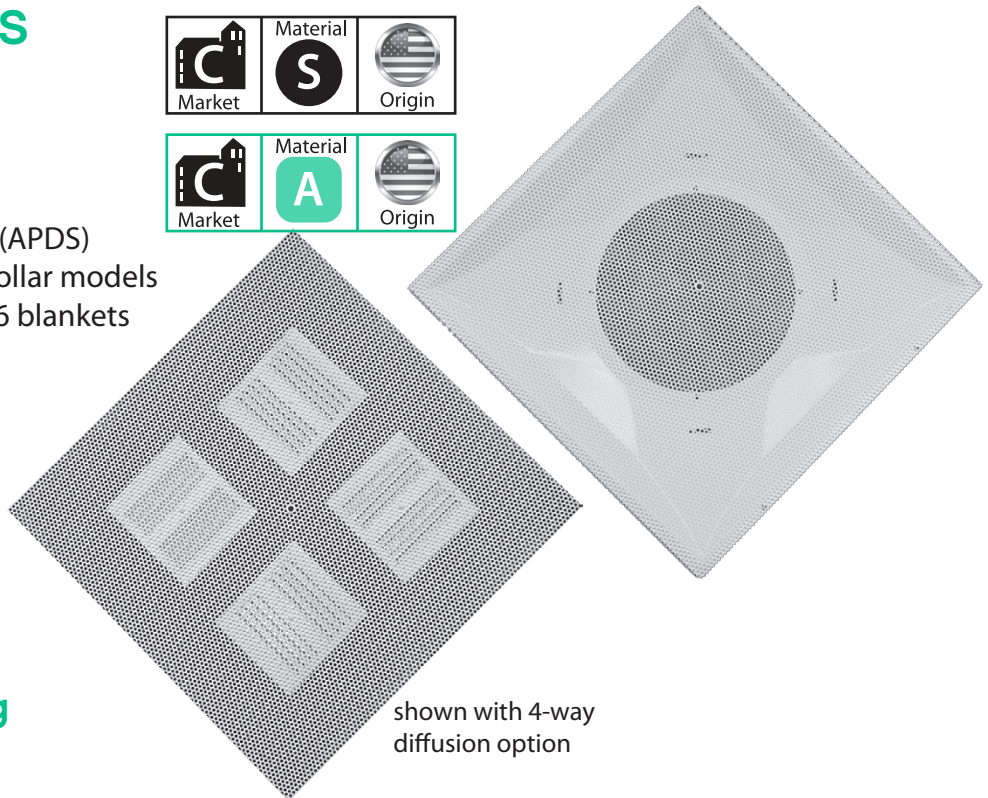

Dimensional Drawing

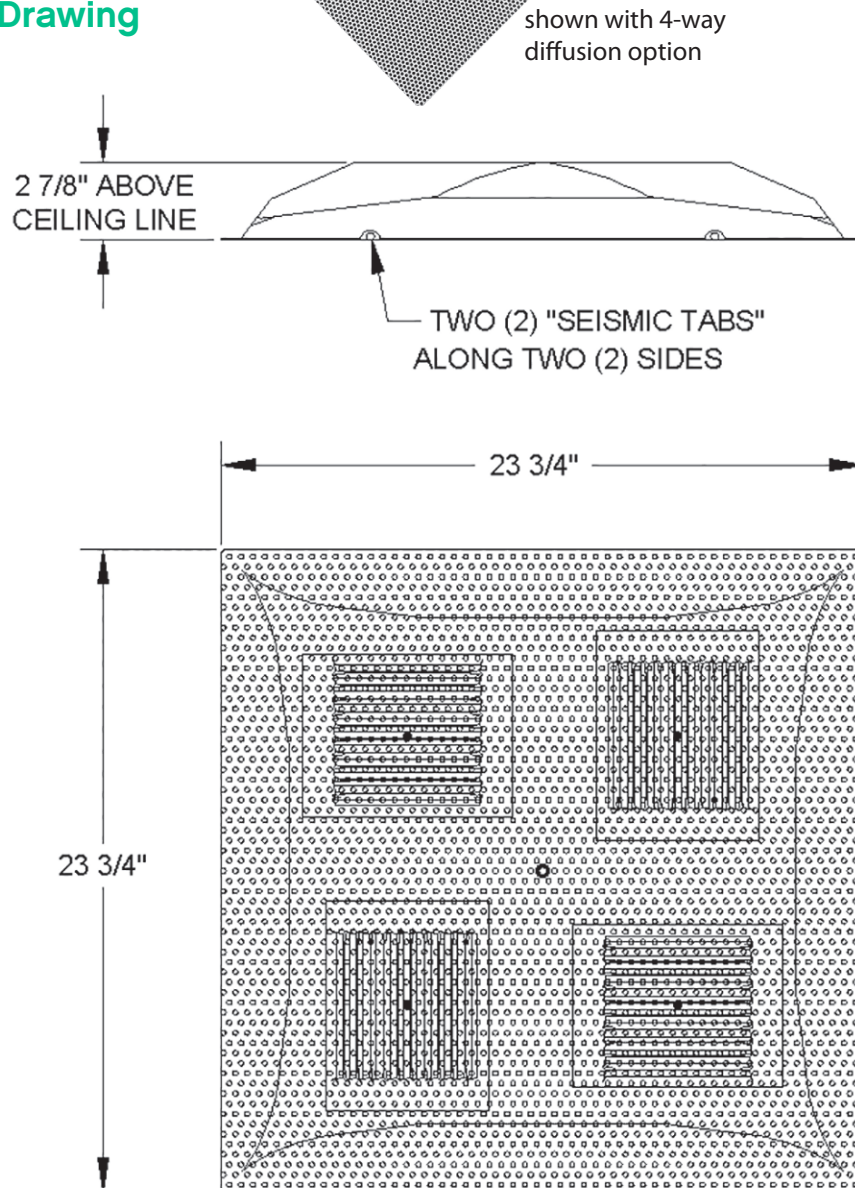

Commercial
T-bar (lay-in)

Performance Data, Series PDS/APDS

| Collar Size ↓ | Neck Velocity → | 300 | 400 | 500 | 600 | 700 | 800 | 900 | 1000 |
|------------------|--------------------|--------|--------|--------|-------|-------|-------|--------|--------|
| 6" An .20 | Cfm | 59 | 79 | 98 | 118 | 137 | 157 | 177 | 196 |
| | Ps | <.01 | <.01 | .013 | .017 | .024 | .031 | .039 | .047 |
| | Nc | <20 dB | <20 dB | <20 dB | 22 dB | 26 dB | 30 dB | 35 dB | 40 dB |
| | Throw | 4 | 5 | 6 | 7 | 9 | 10 | 12 | 15 |
| 7" An .27 | Cfm | 80 | 107 | 134 | 160 | 187 | 214 | 241 | 267 |
| | Ps | <.01 | .01 | .014 | .019 | .027 | .034 | .043 | .053 |
| | Nc | <20 dB | <20 dB | 20 dB | 24 dB | 28 dB | 34 dB | 38 dB | 42 dB |
| | Throw | 5 | 6 | 7 | 9 | 11 | 12 | 14 | 15 |
| 8" An .35 | Cfm | 105 | 140 | 175 | 209 | 244 | 279 | 314 | 349 |
| | Ps | <.01 | .01 | .015 | .021 | .031 | .038 | .049 | .059 |
| | Nc | <20 dB | <20 dB | 21 dB | 26 dB | 31 dB | 39 dB | 42 dB | >45 dB |
| | Throw | 6 | 7 | 9 | 11 | 12 | 14 | 15 | 17 |
| 9" An .44 | Cfm | 133 | 177 | 221 | 265 | 309 | 353 | 398 | 442 |
| | Ps | <.01 | .011 | .017 | .024 | .033 | .043 | .054 | .066 |
| | Nc | <20 dB | <20 dB | 21 dB | 26 dB | 34 dB | 40 dB | 43 dB | >45 dB |
| | Throw | 7 | 8 | 10 | 13 | 15 | 17 | 19 | 21 |
| 10" An .54 | Cfm | 164 | 218 | 273 | 327 | 282 | 436 | 491 | 545 |
| | Ps | <.01 | .012 | .019 | .027 | .037 | .048 | .061 | .075 |
| | Nc | <20 dB | <20 dB | 21 dB | 26 dB | 34 dB | 40 dB | 43 dB | >45 dB |
| | Throw | 8 | 10 | 13 | 16 | 18 | 21 | 24 | 26 |
| 12" An .78 | Cfm | 236 | 314 | 393 | 471 | 550 | 628 | 707 | 785 |
| | Ps | <.01 | .014 | .022 | .033 | .045 | .061 | .075 | .093 |
| | Nc | <20 dB | 20 dB | 25 dB | 33 dB | 40 dB | 44 dB | >45 dB | >45 dB |
| | Throw | 10 | 12 | 16 | 19 | 21 | 24 | 27 | 29 |
| 14" An 1.07 | Cfm | 321 | 428 | 535 | 641 | 748 | 855 | 962 | 1069 |
| | Ps | <.01 | .017 | .027 | .040 | .055 | .075 | .093 | .115 |
| | Nc | <20 dB | 20 dB | 25 dB | 30 dB | 38 dB | 45 dB | >45 dB | >45 dB |
| | Throw | 11 | 14 | 19 | 22 | 25 | 28 | 31 | 34 |

Terminal velocity = 75 fpm